

Title of Change:	FGD3050G2 Datasheet Errata.
Effective date:	03 Sep 2022
Contact information:	Contact your local onsemi Sales Office or karjoon.lee@onsemi.com
Type of notification:	This Product Bulletin is for notification purposes only. onsemi will proceed with implementation of this change upon publication of this Product Bulletin.
Change Category:	Datasheet Errata
Change Sub-Category(s):	Datasheet/Product Doc change

Sites Affected:

onsemi Sites	External Foundry/Subcon Sites
None	None

Description and Purpose:

Dim	Datasheet		Case Outline	
	Min	Max	Min	Max
A1	6.4	6.8	6.35	6.73
A2	5.04	5.64	5.21	5.46
A3	4.34		NA	
A4	0.4	0.8	0.89	1.27
B1	0.5	0.6	0.45	0.58
B2	2.2	2.4	2.18	2.39
B3	9.2	9.8	9.4	10.41
C1	5.9	6.3	5.97	6.22
C2	0.66	0.86	0.64	0.89
C3	4.4	4.8	4.57	
C4	2.3		2.29	
C5	0.6	1		1.02
C6		0.96	0.76	1.14
D1	0.4	0.6	0.45	0.61
D2	1.34	1.54	1.4	1.78
D3	2.15	2.55	2.9	

Delta	Min	Max
		-0.17
	-0.49	-0.47
		0.02
		0.01
	-0.2	
	-0.07	0.08
	-0.05	
	-0.06	

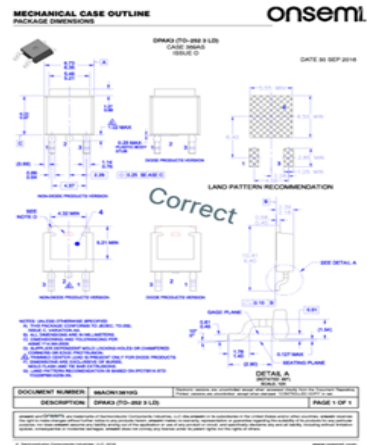
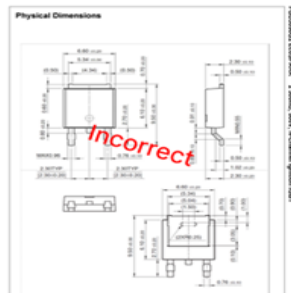

Correct dimensions are the 369AS case outline

Dim	Datasheet		Case Outline	
	Min	Max	Min	Max
A1	6.4	6.8	6.35	6.73
A2	5.04	5.64	5.21	5.46
A3	4.34		NA	
A4	0.4	0.8	0.89	1.27

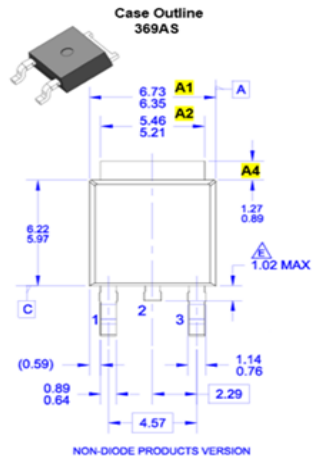

Correct dimensions are the 369AS case outline

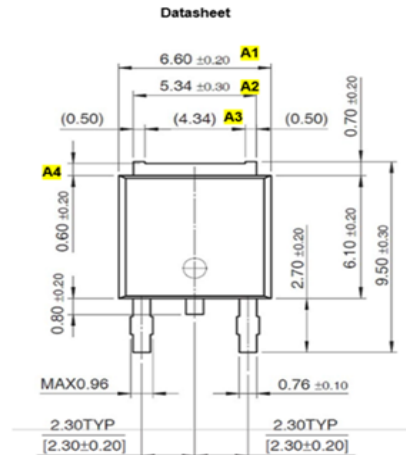

	Datasheet		Case Outline	
B1	0.5	0.6	0.45	0.58
B2	2.2	2.4	2.18	2.39
B3	9.2	9.8	9.4	10.41

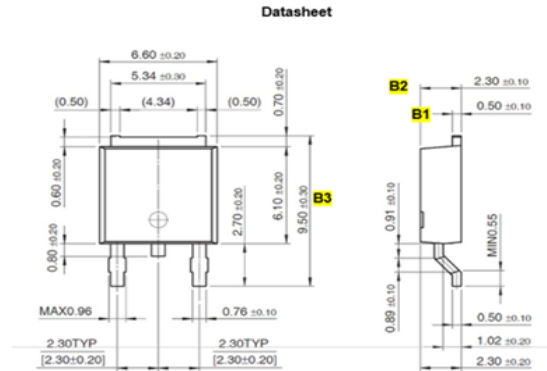
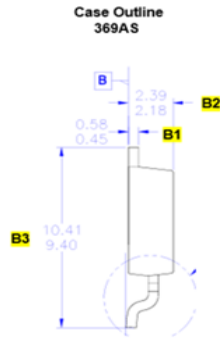

Correct dimensions are the 369AS case outline

Dim	Datasheet		Case Outline	
	Min	Max	Min	Max
C1	5.9	6.3	5.97	6.22
C2	0.66	0.86	0.64	0.89
C3	4.4	4.8	4.57	
C4	2.3		2.29	
C5	0.6	1		1.02
C6		0.96	0.76	1.14

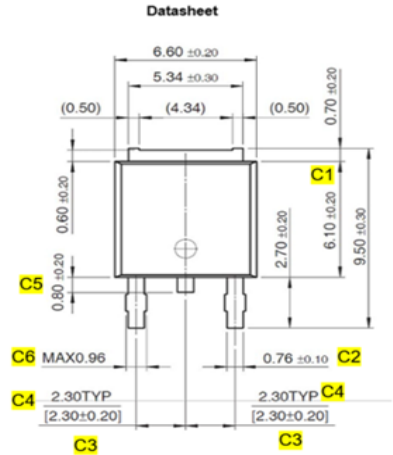
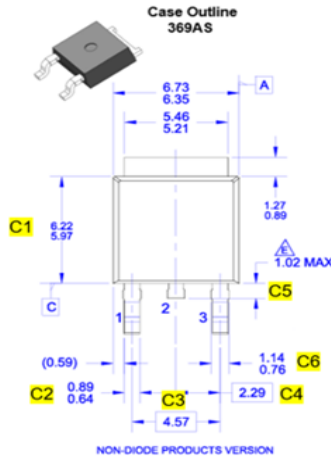

Correct dimensions are the 369AS case outline

	Datasheet		Case Outline	
D1	0.4	0.6	0.45	0.61
D2	1.34	1.54	1.4	1.78
D3	2.15	2.55	2.9	

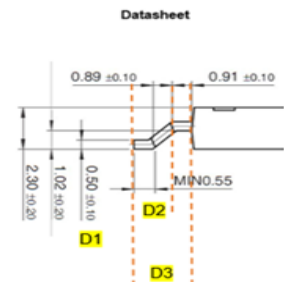
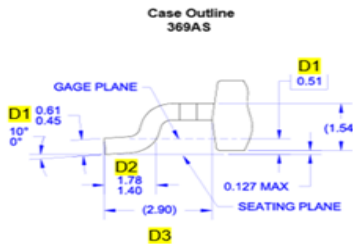

Correct dimensions are the 369AS case outline

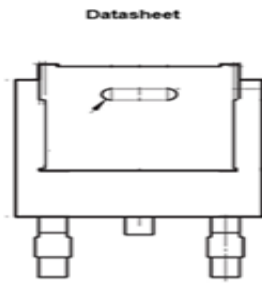

Incorrect

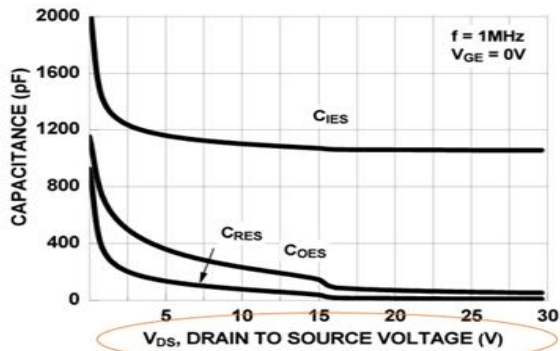
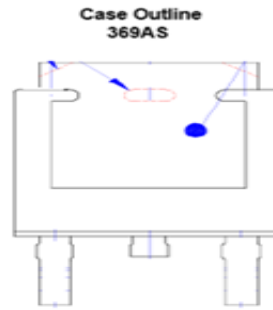

Figure 13. Capacitance vs. Collector to Emitter Voltage



Correct

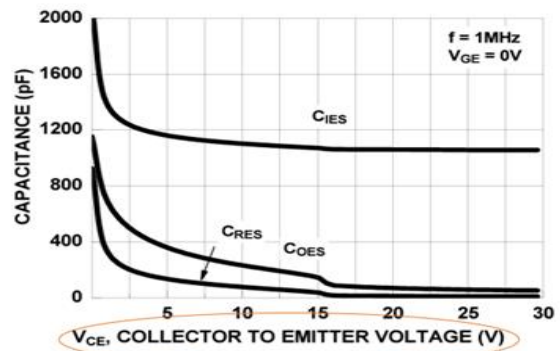

Figure 13. Capacitance vs. Collector to Emitter Voltage

List of Affected Standard Parts:

Note: Only the standard (off the shelf) part numbers are listed in the parts list. Any custom parts affected by this PCN are shown in the customer specific PCN addendum in the PCN email notification, or on the [PCN Customized Portal](#).

FGD3050G2		
-----------	--	--