



480 LEDs/m COB LED Strip



Product Description

What is a COB LED Strip Light ? Compared to the SMD 2835: 1 chip on board, or 5050: 3 chips on board, a COB(Chip On Board) LED light has multiple chips on the same PCB (Printed Circuit Board),which make the emitting units unprecedentedly close to each other, and create super even lighting performance



The Highlights of COB: Lower power, higher light efficiency (110LM/W),higher CRI(85+). 180 degrees beam angle design for 50% wider lighting,multiple chips on board for uniform illumination,NO MORE worries about dark spot!



Product Datasheet

Product Number	S008480ZB1LZ
Voltage	DC12V
SMD Type	COB
Beam Angle	180°
LED Quantity	480 leds/m
CRI	≥90RA
CCT	6500±300K
Lumens/m	1100Lm
PCB color	White
Power (W)	10W/M
Size (mm)	L 5000* W 8
IP	IP 20/IP 65
Net Weight	0.13kg/roll
Operation Temperature	- 25 ~ 45 °C

Application



DIY and DIMMABLE: With stronger 3M adhesive,our COB LED strip lights can be reliably installed, idea for kitchen,cabinet,bedroom,stair,mirror,corridor,DIY backlight, table lamp,toy light,mirrors,walls,cabinets and other places that need decoration

Hotels ,restaurants, nights clubs, edge light

Living rooms, coffee / wine bars, back lighting

Recreational machines, playstation

TV, dancefloor background, shopping malls,



Strip IP Rate

Heat shrinkable tube



Silicone tube

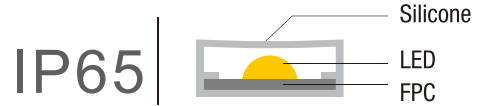
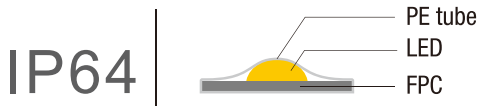

Product connections



Insert each ends of led strips into the end of the connection terminal respectively, make sure the metal clip is on the same side as the metal solder pad of led strip.



After complete the insert, also make sure both ends of led strip are tightly connected

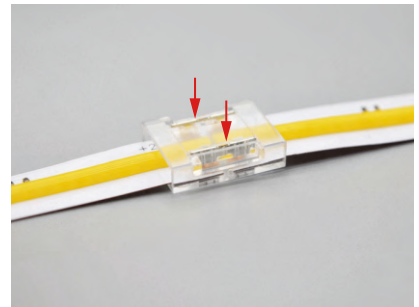

Press the metal clip down with the appropriate force using pliers to ensure that the metal clip is inserted into the appropriate position ,and connection completed.

Wiring connections

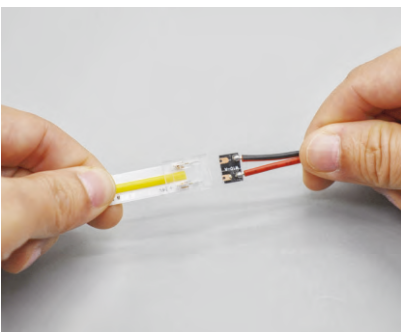

Insert one end of led strip and wire connector into both ends of the connection terminal respectively to ensure that the metal clip is on the same side as the metal solder pad of led strip



Meanwhile make sure both ends are closely connected, Press the metal clip down with the appropriate force using pliers to ensure that the metal clip is inserted into the appropriate position ,and connection completed.



Matters needing attention

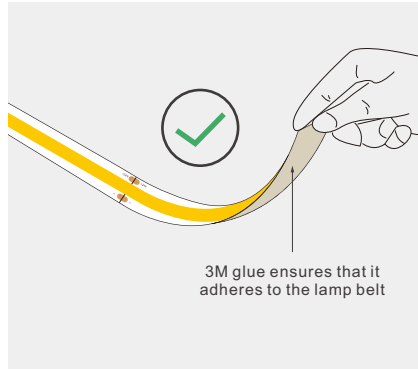
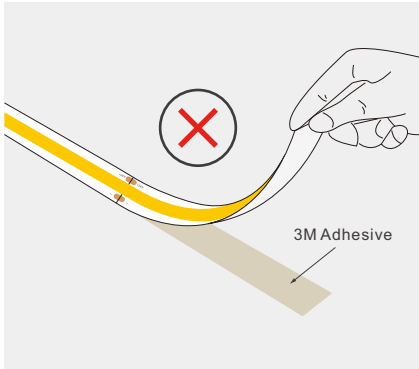

If you need to tear up the LED tape again, 3M glue ensures that it adheres to the lamp belt, otherwise it will Damage LED tape

When install the led strip,please note the installation technique.The led strip can be bent, but not distorted,as shown below.

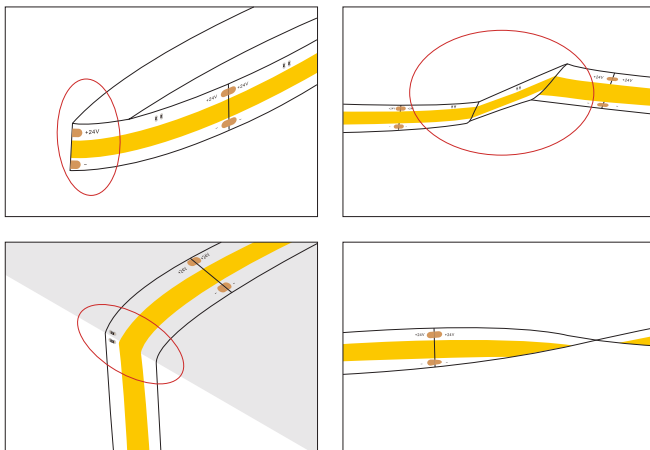

Distortion(Wrong)

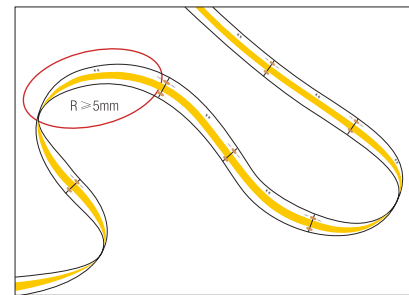

Bend(Right)

➤ LED strips are low voltage products,you must use the power supply(transformer).Please don,t connect the led strip directly to the AC 110v or AC 220v,otherwise it will burn out the LED strips.

➤ Clean up the installation surface,it will ensure the reliability of the adhesive,The electrical connection process must be operated by a professional person.



Product packaging

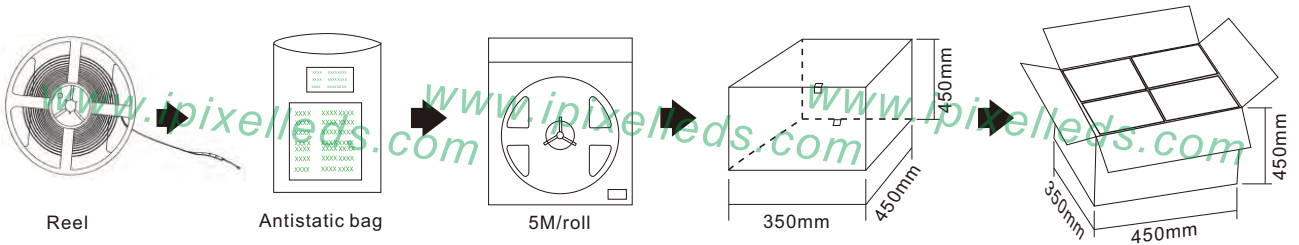

Product number	Standard length	Quantity / volume	outer carton size	Weight(kg)/reel
S008320ZC1LZ(IP20)	5M	240 Reels	L450xW350xH450mm	0.13kg
/				/
/				/
/				/
/				/
/				/