



# 1995 MHz Ceramic Bandpass Filter

Part Number: AM1995B1592



**ANATECH ELECTRONICS INC**  
RF & Microwave Filters & Products

## Electrical specifications

**Center Frequency:** 1995 MHz  
**Bandwidth(BW):** 30 MHz  
**Insertion loss(Fo):** 2.5 dB max  
**Ripple in Bw:** 1.0 dB max  
**VSWR:** 1.5:1 Min  
**Attenuation 1:** 50 dB min @1672.8~1702.8 MHz  
**Attenuation 2:** 38 dB min @1826.4~1856.4 MHz  
**Attenuation 3:** 50 dB min @2170~2200 MHz  
**Group delay variation:** 10 nsec max  
**In/Out Impedance:** 50 Ohm  
**Input power:** 3 Watt max

## Mechanical

**Mounting Method:** SMT  
**Dimensions:** 13 X 14 X 4.5 mm

## Environmental

**Operating Temperature:** -45 to +85° C  
**Storage Temperature:** -55 to +95° C  
**Shock:** 20 G. 11ms  
**Vibration:** 20 G. 5 to 200 MHz

This product is RoHS compliant.

## Outline Drawing:

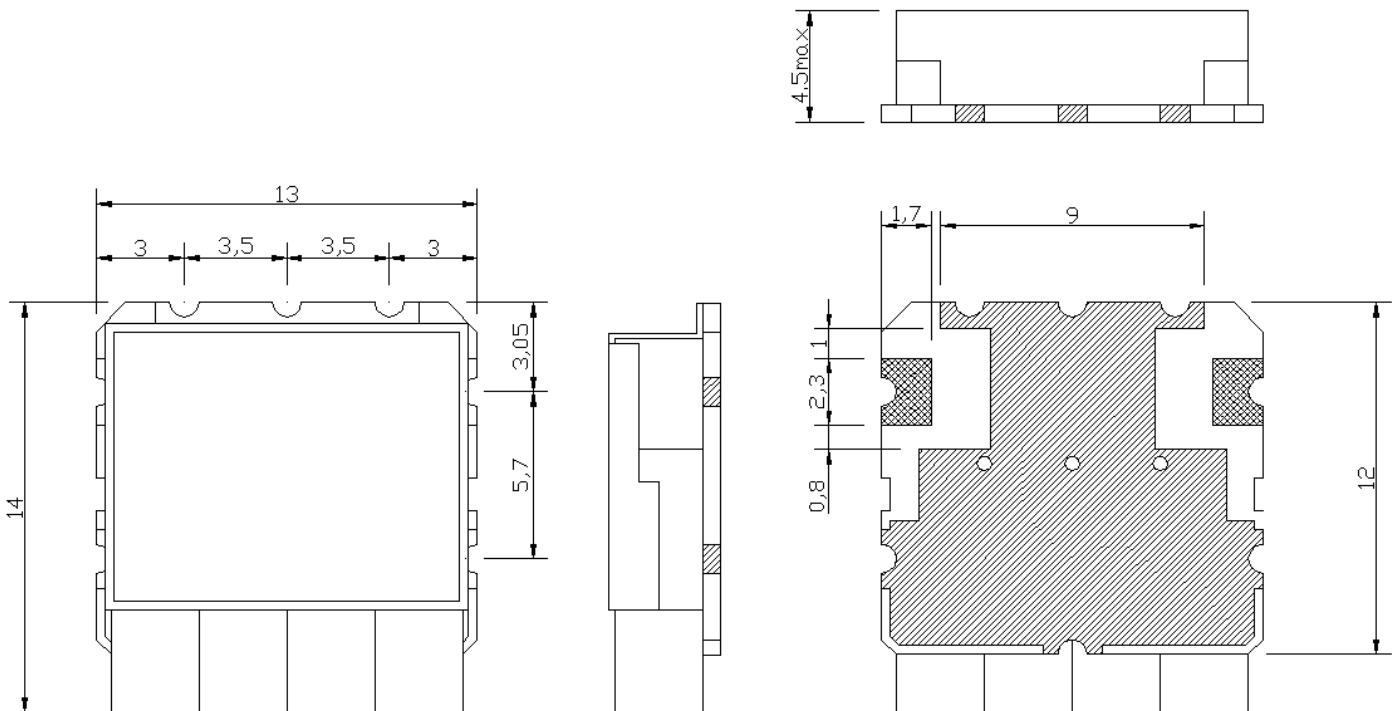

Unit:mm  
Tolerance:±0.3