

FP18591\_LISA3CSP-0-90-CLIP16

**COMPONENTS**

INDEX	PART	TYPE	MATERIAL	COLOR / COATING
1	F16556_LISA3-0	LENS	PMMA	CLEAR
2	F18197_LISA3-HLD2-CLIP16	HOLDER	PC	BLACK

**MECHANICAL DRAWING**

PRODUCT  
**LISA3**

Plastic moulding general tolerances according to DIN 16901-130 and applies if not otherwise shown in the drawing. Silicone moulding general tolerances according to ISO 3302-1 Class M3 and applies if not otherwise shown in the drawing.

FIRST ANGLE PROJECTION:

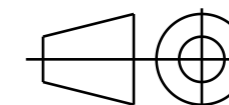

**LEDiL**

This drawing is the property of LEDiL Oy. It may not be copied or otherwise distributed without prior written permission from LEDiL Oy.

SCALE 1:1

WEIGHT 0,42 g

A3 SHEET 1/1

**Notes**

	PCB or heatsink level.
	LED location
	Ensure LED fitting from a product specific 3D model available from <a href="http://www.ledil.com">www.ledil.com</a>
	For more details about installation please see LEDiL Installation Guide on <a href="http://www.ledil.com">www.ledil.com</a>