



ANATECH ELECTRONICS INC
RF & Microwave Filters & Products

2100 MHz Ceramic Bandpass Filter

Part Number: AM2100B1298



Electrical specifications

Center Frequency: 2100 MHz
Bandwidth: 166 MHz min
VSWR: 1.33 : 1
Input / Output Impedance: 50 Ohms
Passband: 2017-2183 MHz
Passband Insertion Loss: 1.5 dB max
Passband Ripple: 1.0 dB max
Rejection: 46 dB min at 1745 MHz
Rejection 2: 25 dB min at 2380-2400 MHz
Rejection 3: 46 dB min at 2800-4000 MHz
Power Handling: 2 watt max

Mechanical

Mounting Method: SMT
Dimensions: 13 x 12 x 4.5 mm

Environmental

Operating Temperature: -40°C to 85°C
Storage Temperature: -50°C to +90°C

This product is RoHs compliant.

Outline Drawing:

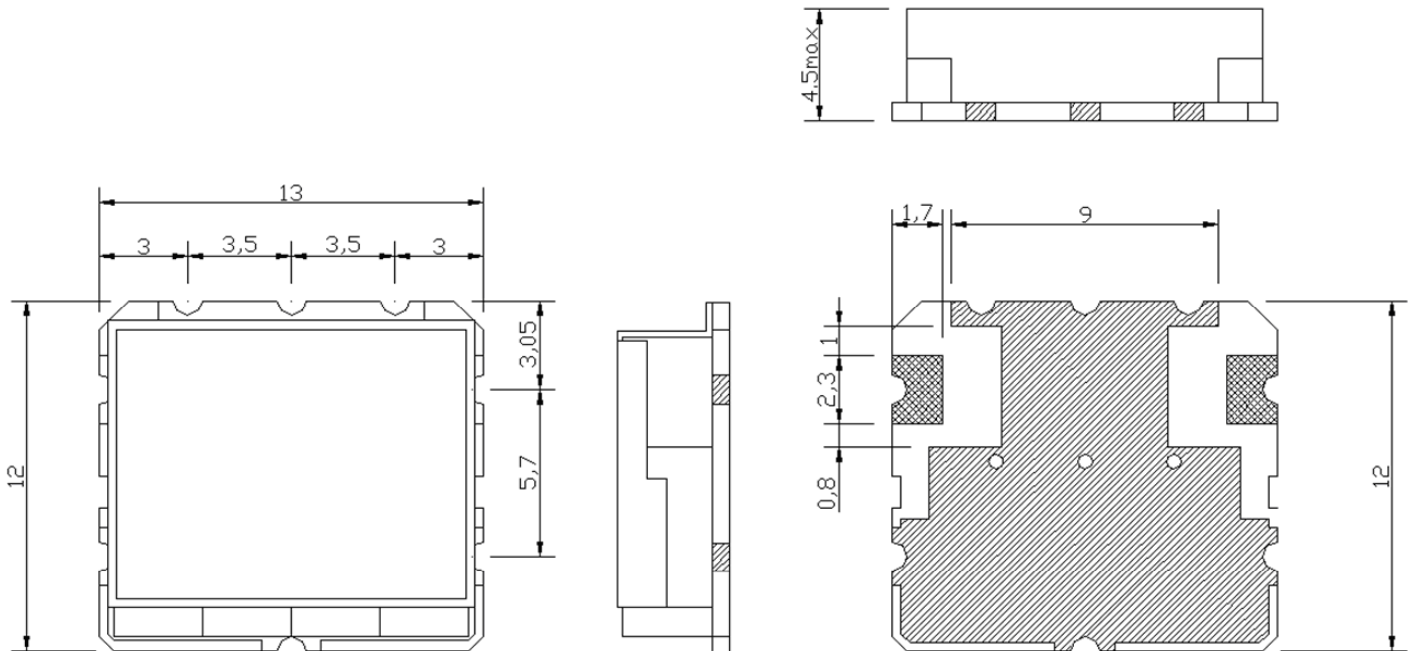

Unit:mm
Tolerance:±0.3