

**Dimensions mm[inch]**  
tolerances acc. to DIN ISO 2768-m  
Toleranzen gem. DIN ISO 2768-m

**Isometric**  
Scale 2:1  
Maßstab 2:1

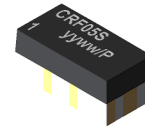

**Post reflow hight**

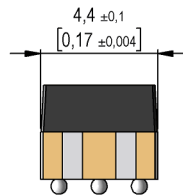
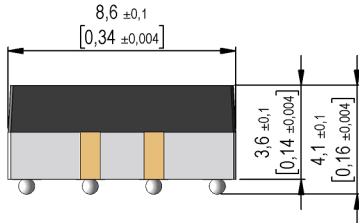
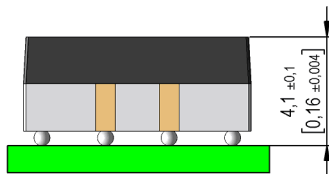

**Layout**

Top view  
Draufsicht

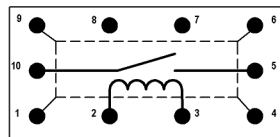

**Marking**

according to EN60062/factory code  
gem. EN60062/Fertigungsstätte



**Recommended PCB Pad Layout**

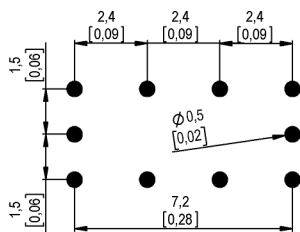

**Recommended Reflow Lead-free Profile**

(acc. to JEDEC J-STD 020D.1)  
for usage with a tin Sn96.5/Ag3/Cu0.5

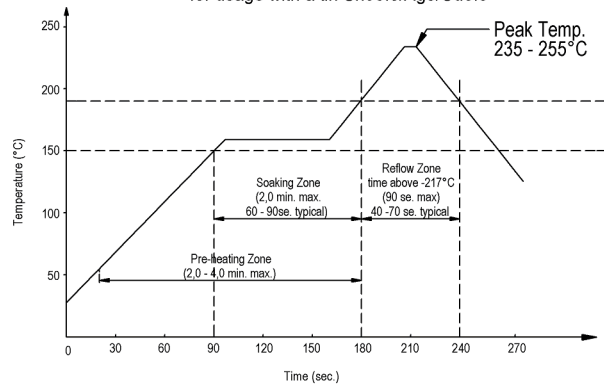

**Relay packaging orientation**

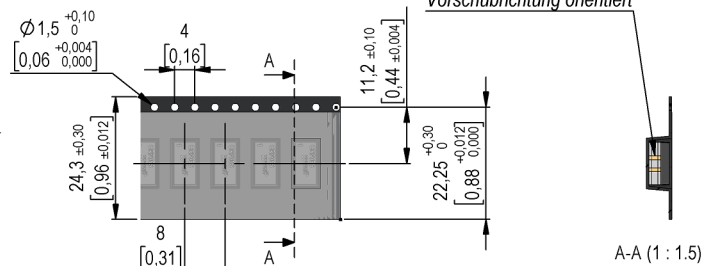
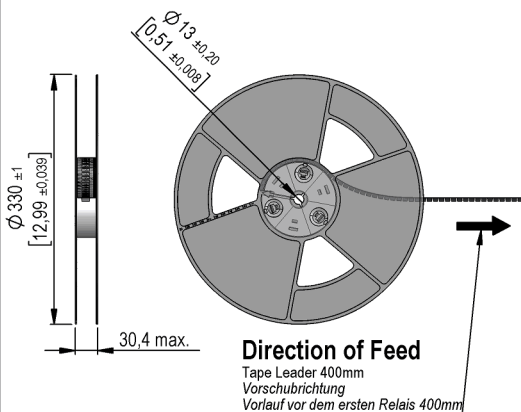



Europe: +49 / 7731 8399 0

| Email: info@standexmeder.com

Item No.:

USA: +1 / 508 295 0771

| Email: salesusa@standexmeder.com

**9605180020**

Asia: +852 / 2955 1682

| Email: salesasia@standexmeder.com

Item:

**CRF05-1AS**

| Coil Data at 20 °C | Conditions | Min  | Typ | Max  | Unit |
|--------------------|------------|------|-----|------|------|
| Coil resistance    |            | 135  | 150 | 165  | Ohm  |
| Coil voltage       |            |      | 5   |      | VDC  |
| Rated power        |            |      | 167 |      | mW   |
| Pull-In voltage    |            |      |     | 3,75 | VDC  |
| Drop-Out voltage   |            | 0,75 |     |      | VDC  |

| Contact data 80           | Conditions  | Min     | Typ | Max  | Unit |
|---------------------------|---|---------|-----|------|------|
| Contact-material          |   | Rhodium |     |      |      |
| Contact-rating            | Any DC combination of V & A not to exceed their individual max.'s |         |     | 10   | W    |
| Switching voltage         | DC or Peak AC   |         |     | 170  | V    |
| Switching current         | DC or Peak AC   |         |     | 0,5  | A    |
| Carry current             | DC or Peak AC   |         |     | 1    | A    |
| Contact resistance static | Measured with 40% overdrive Start Value                           |         |     | 200  | mOhm |
| Insulation resistance     | RH <45 %, 100 V test voltage                                      | 10      | 100 |      | GOhm |
| Breakdown voltage         | according to EN 60255-5   | 210     |     |      | VDC  |
| Operate time incl. bounce | measured with 40% overdrive                                       |         |     | 0,6  | ms   |
| Release time              | measured with no coil excitation                                  |         |     | 0,05 | ms   |
| Capacitance               | @ 10 kHz above open switch  |         | 0,3 | 0,5  | pF   |

| Special Product Data               | Conditions                               | Min   | Typ | Max | Unit  |
|------------------------------------|--|---|-----|-----|-------|
| Number of contacts                 |  | 1   |     |     |       |
| Contact - form                     |  | A - NO  |     |     |       |
| Contact Bulk Resistance            | Through all plated material on substrate |   | 260 | 440 | mOhm  |
| Dielectric Strength Coil/Contact   | according to EN 60255-5                  | 1,5   |     |     | kV DC |
| Insulation resistance Coil/Contact | RH <45%, 200 VDC Measuring Voltage       | 10  | 100 |     | TOhm  |
| Capacitance Coil/Contact           | @ 10 kHz                                 |   | 0,9 | 1,1 | pF    |
| Case color                         |  | black/white                                     |     |     |       |
| Housing material                   |  | Ceramic + mineral filled epoxy                  |     |     |       |
| Material connection pads           |  | BGA solderballs D=0,025" (Sn96,5 AG3 Cu0,5)     |     |     |       |
| Magnetic Shield                    |  | yes, internal                                   |     |     |       |
| Remark                             |  | RF Data and S-Parameters available upon request |     |     |       |
| Approval                           |  | UL-File No. NRNT2.E156887                       |     |     |       |
| Reach / RoHS conformity            |  | yes   |     |     |       |

| Environmental data          | Conditions                         | Min          | Typ | Max | Unit |
|-----------------------------|------------------------------------|--------------|-----|-----|------|
| Shock                       | 1/2 sine, duration 11ms, in 3 axis |              |     | 50  | g    |
| Vibration                   | from 10 - 2000 Hz                  |              |     | 20  | g    |
| Operating temperature       |                                    | -40          |     | 125 | °C   |
| Storage temperature         |                                    | -55          |     | 125 | °C   |
| Soldering Temperature Tsold | Reflow acc.IPC/JEDEC J-STD-020D.1  |              |     | 255 | °C   |
| Washability                 |                                    | fully sealed |     |     |      |

| General data | Conditions | Min                     | Typ  | Max | Unit |
|--------------|------------|-------------------------|------|-----|------|
| Total weight |            |                         | 0,38 |     | g    |
| Packaging    |            | Tape & Reel / 1000 pcs. |      |     |      |

Modifications in the sense of technical progress are reserved

Designed at: 27.01.11 Designed by: CRUF

Approval at: 27.01.11 Approval by: CRUF

Last Change at: 26.09.17 Last Change by: WKOVACS

Approval at: 26.10.17 Approval by: DSTASTNY

Version: 06