



ANATECH ELECTRONICS INC
RF & Microwave Filters & Products

428 MHz LC Band Pass Filter

Part Number: AE428B6224



Electrical Specifications

Center Frequency: 428 MHz
Passband: 406-450 MHz
Insertion Loss: 3.0dB Max.
Return Loss: 14dB Min.
Rejection1: ≥ 30dB @ 370 MHz
Rejection2: ≥ 30dB @ 478 MHz

Mechanical

Connector Type: PC-Mount
Dimensions: 1.5" X 0.75" x 0.5" .

Environmental

Operating Temperature: -25°C to +70°C
Storage Temperature: -40°C to +90°C
Shock: 10 G. 11ms
Vibration: 10 G. 5 to 200Hz

Outline Drawing:

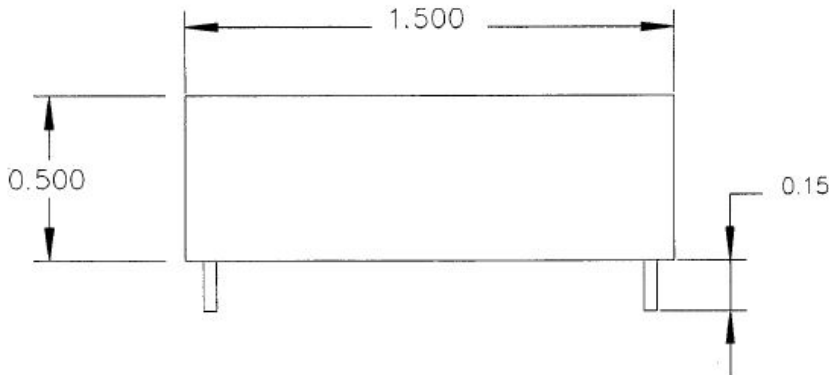

IN/OUT pin 0.02" dia, GND pin 0.04" dia

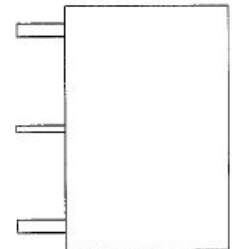
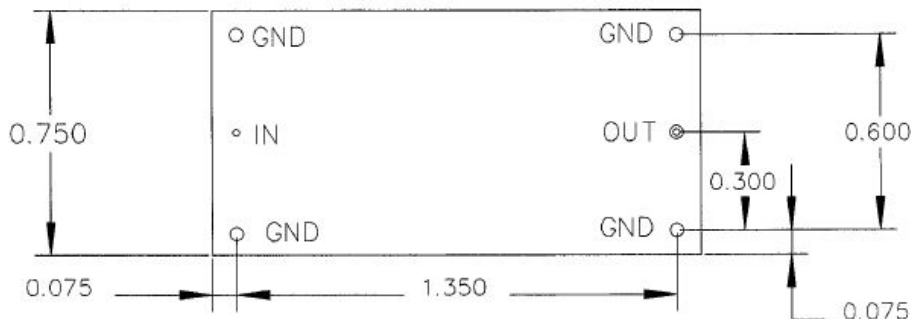



ANATECH ELECTRONICS INC
RF & Microwave Filters & Products

428 MHz LC Band Pass Filter

Part Number: AE428B6224



Response Plot:

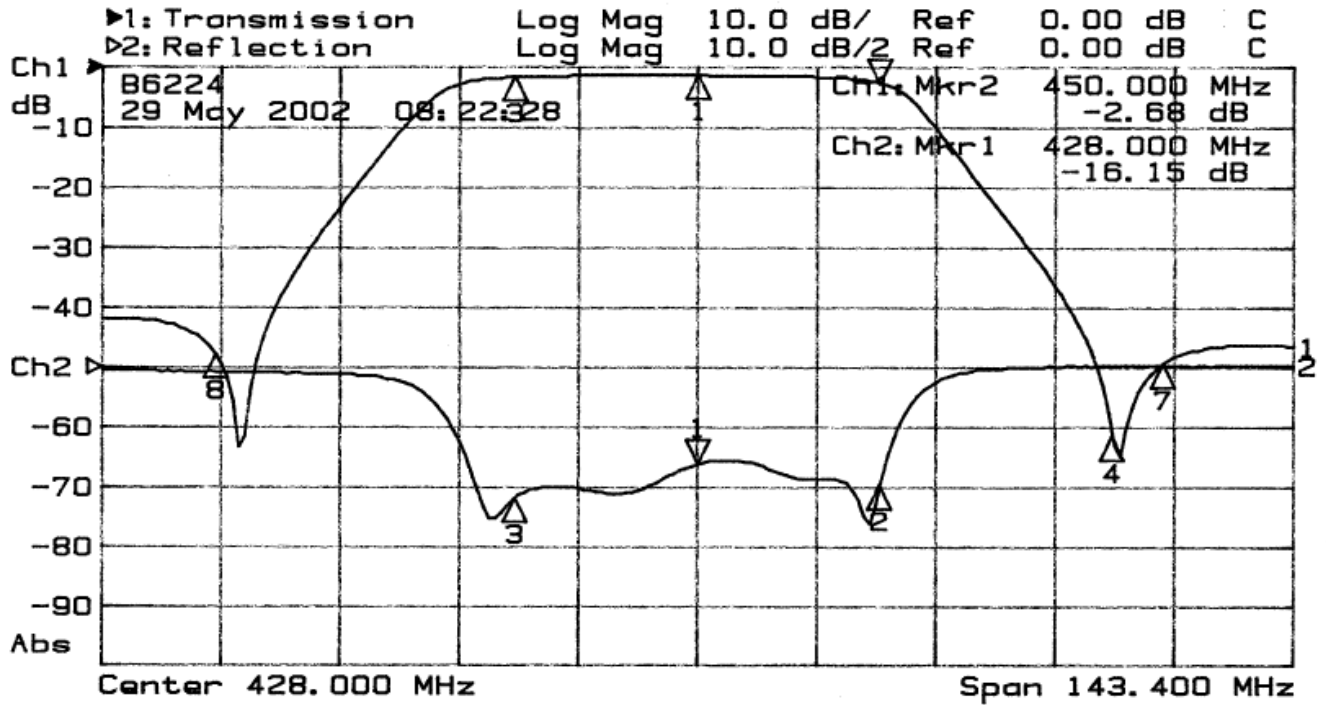

1: Mkr (MHz)	dB	2: Mkr (MHz)	dB		
1:	428.00	-1.40	1>	428.00	-16.15
2>	450.00	-2.68	2:	450.00	-19.77
3:	406.00	-1.62	3:	406.00	-21.81
4:	478.00	-61.71			
7:	484.00	-49.41			
8:	370.00	-47.96			